

2 1/2" Tilter Instructions

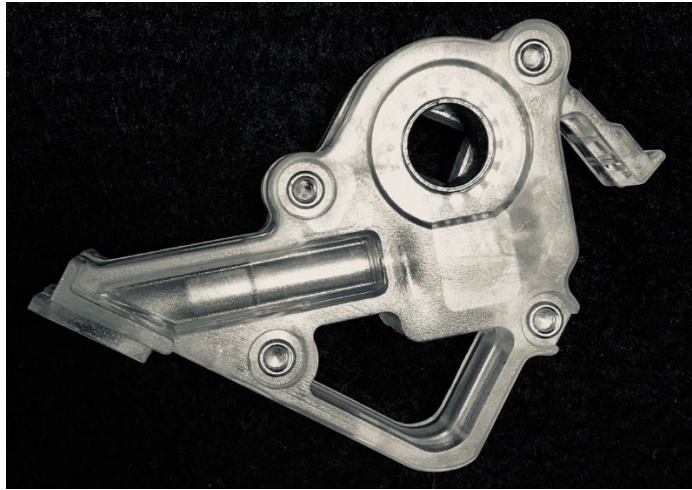

Tilter mechanism (already mounted inside headrail)



Tilter stem (inside hardware box or taped to headrail)

On the 2 1/2" blinds, the tilter mechanism comes partially disassembled. You will have to plug the stem into the mechanism like so:

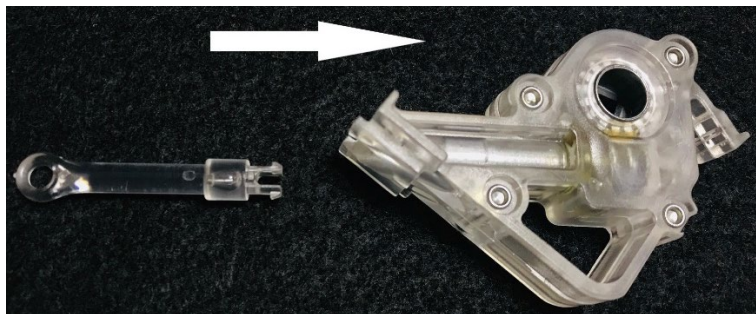

Once plugged into the tilter, the stem cannot be removed.